

Types of mounting

Egger axial pumps are specially fabricated to customer requirements and exist in various types of mounting. They are available clockwise and counter clockwise as well as in cast or welded constructions. Special designs for temperatures up to 280°C and pressures up to 25 bar already exist. Versions with special dimensions allow easy adaption to existing elbow systems.

Foot-mounted on baseplate

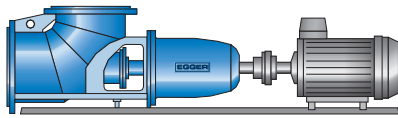

Direct-coupled

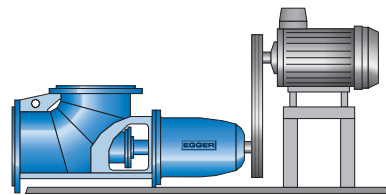

V-belt drive

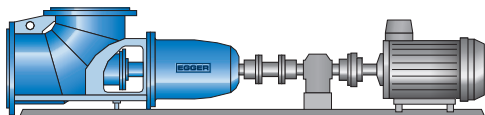

Spur gear drive

Special designs on request

Pump suspended in the pipeline

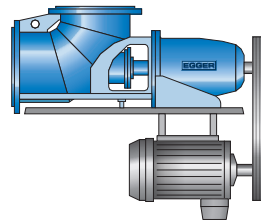

Motor suspended, V-belt drive

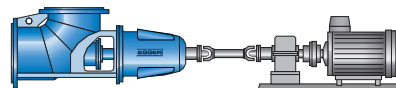

Universal joint drive with spur gear

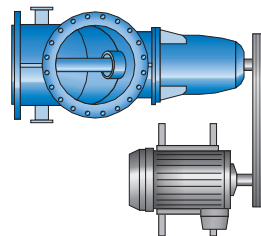

Motor assembled adjacent, on slide rails

Special designs

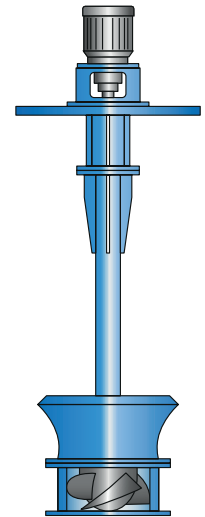

Recirculation propeller

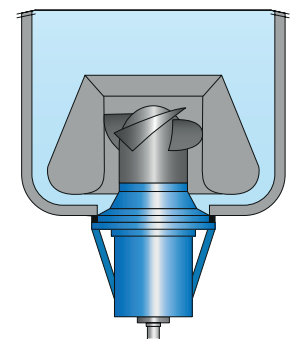

Internal tank circulation

1103.en - 09.2016

Headquarter

Emile Egger & Cie SA
Route de Neuchâtel 36
2088 Cressier NE (Switzerland)
Phone +41 (0)32 758 71 11
Fax +41 (0)32 757 22 90
info@eggerpumps.com

Offices and representatives countries

Austria	India	USA
Belgium	Italy	
China	Netherland	
France	Spain	
Germany	Sweden	
Great Britain	Switzerland	



Further information can be found on:
www.eggerpumps.com